

# Snap-Fit Grip Plugs with large flange

With large full Protection Flange

Single turn gives tight fit once pushed into position

Designed with flexible fins each plug covers a wide range of threads

strong

FLEXIBLE  
PRODUCTION

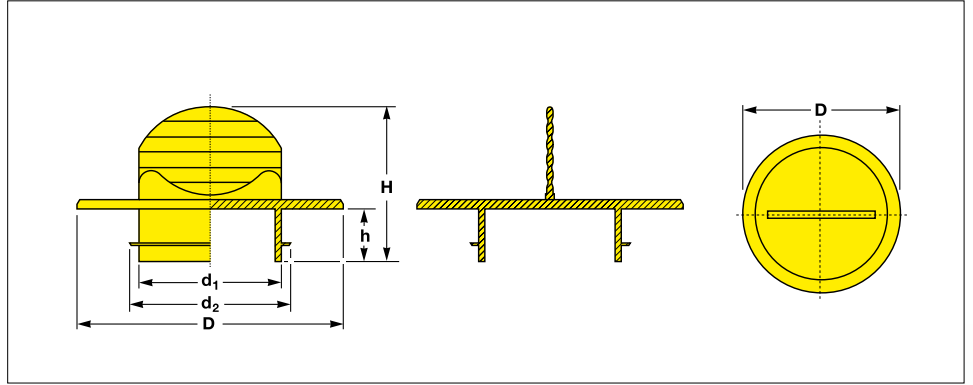

All dimensions in mm

**Material :**  
LLD-PE,  
linear low density polyethylene

**Standard Colour :**  
yellow

Single turn gives tight fit once  
pushed into position.

With large full Protection Flange.

Designed with flexible fins each plug  
covers a wide range of threads.

Think Plastic. Go Protec.®

**PROTEC**  
**PLASTICS**

D	d <sub>1</sub>	d <sub>2</sub>	h	H	Reference No.
25.0	5.0	8.0	8.0	25.0	EP 360 / GS 8
27.0	7.0	10.0	8.0	25.0	EP 360 / GS 10
29.0	9.0	12.0	8.0	25.0	EP 360 / GS 12
31.0	11.0	14.0	8.0	25.0	EP 360 / GS 14
33.0	13.0	16.0	8.0	25.0	EP 360 / GS 16
35.0	15.0	18.0	8.0	25.0	EP 360 / GS 18
39.0	19.0	22.0	8.0	25.0	EP 360 / GS 22
42.9	23.0	26.0	8.0	25.0	EP 360 / GS 26
47.0	27.0	30.0	8.0	25.0	EP 360 / GS 30
49.0	29.0	32.0	8.0	25.0	EP 360 / GS 32
51.0	31.0	34.0	8.0	27.0	EP 360 / GS 34
58.0	38.0	41.0	8.0	27.0	EP 360 / GS 41
63.3	44.0	47.0	8.0	27.0	EP 360 / GS 47
75.0	55.0	58.0	8.0	27.0	EP 360 / GS 58
92.0	72.0	75.0	8.0	27.0	EP 360 / GS 75
99.0	79.0	84.0	8.0	27.0	EP 360 / GS 82 - 84
103.0	83.0	86.0	8.0	27.0	EP 360 / GS 86

Should your requirements not be shown please ask for separate quotation.

PROTEC products and specifications are subject to improvement and change without notice.

# Snap-Fit Grip Plugs with large flange

With large full Protection Flange

Single turn gives tight fit once pushed into position

Designed with flexible fins each plug covers a wide range of threads

## TRIPLE ADVANTAGE of PROTEC CAPTOP®

**QUALITY.** Single turn gives tight fit once pushed into position. With large full Protection Flange. Designed with flexible fins each plug covers a wide range of threads.

**AVAILABILITY.** With over 400 million moulded components shipped from our Oststeinbek / Hamburg logistics center we provide the fastest on time delivery service to all markets and industries.

**PHILOSOPHY.** Innovative protective closures at the best price in the market.



### Example of application

All dimensions in mm

Reference No. EP 360/	Metric Thread DIN 13				Whitworth Pipe Thread DIN 259 (DIN ISO 228)	UN Thread to ANSI/ ASME B1.a -1984	UN Thread to ANSI/ ASME B1.a -1984	UN Thread to ANSI/ ASME B1.a -1984	UN Thread to ANSI/ ASME B1.a -1984
	M 8	M 8×1	M 10×1.5	M 12×1.5					
GS 8	M 8	M 8×1			R .1/16"	.5/16"		.5/16"	.5/16"
GS 10		M 10×1	M 10×1.5		R .1/ 8"	.3/ 8"			.3/ 8"
GS 12		M 12×1	M 12×1.5			.1/ 2"	.1/2"		
GS 14		M 14×1	M 14×1.5			.9/16"		.9/16"	.9/16"
GS 16		M 16×1	M 16×1.5	M 17×2	R .3/ 8"	.5/ 8"			.5/ 8"
GS 18		M 18×1	M 18×1.5	M 19×2		.11/16"			
						.3/ 4"			
GS 22	M 24	M 22×1	M 22×1.5	M 23×2	R .5/ 8"	.7/ 8"			.7/ 8"
GS 26		M 26×1	M 26×1.5	M 27×2	M 28×3	R .3/ 4"	1." 1.1/16" 1.1/ 8"	1.1/8"	
GS 30		M 30×1	M 31×2	M 30×2	M 32×3		1.3/16"		1.3/16"
GS 32		M 32×1		M 33×2	M 34×3	R 1."	1.1/ 4"		
GS 34		M 34×1		M 35×2			1.3/ 8"	1.3/ 8"	
GS 41				M 42×2		R 1.1/ 4"	1.5/ 8"		1.5/ 8"
GS 47				M 48×2		R 1.1/ 2"	1.7/ 8"		
GS 58			M 58×1.5			R 2."			
GS 75		M 75×1		M 75×2		R 2.1/ 2"	3."		
GS 82		M 82×1					3.1/ 4"		
GS 86					M 88×3	R 3."			

Should your requirements not be shown please ask for separate quotation.

PROTEC products and specifications are subject to improvement and change without notice.

**Material :**  
LLD-PE,  
linear low density polyethylene

**Standard Colour :**  
yellow

**Individual Productions :**  
On request we develop and produce individually tailored solutions next to the standard items of this range: additional dimensions, different materials and new colours

We would be pleased to advise you.

Think Plastic. Go Protec.®

**PROTEC  
PLASTICS**