

Tapered Protection Plugs / Caps – Side Release Tab

Same body design as previous EP 285 range with large cover flange and side release tab

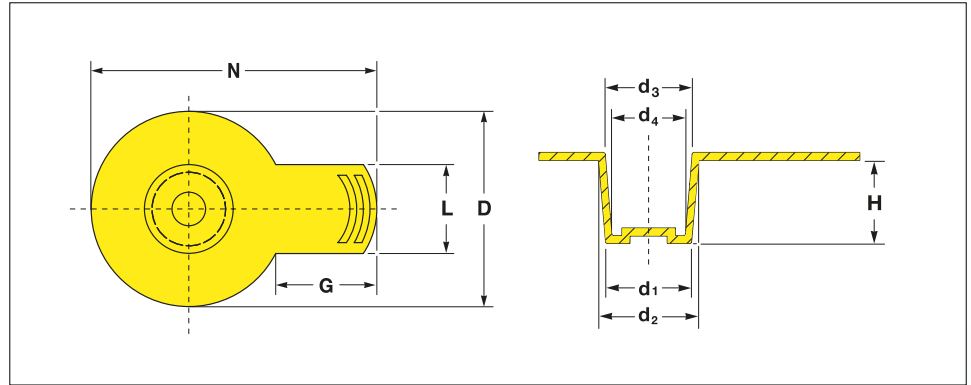

All dimensions in mm

d ₁	d ₂	d ₃	d ₄	H	D	N	G	L	Reference No.
4.4	6.3	4.6	2.7	11.0	22.0	34.5	14.0	11.0	EP 285 B 1-GL
6.0	7.9	6.1	4.3	11.0	23.0	35.5	14.0	11.5	EP 285 B 2-GL
7.6	9.5	7.8	5.9	11.0	25.0	37.3	14.0	12.5	EP 285 B 3-GL
8.4	10.3	8.6	6.8	11.0	26.0	38.3	14.0	13.0	EP 285 B 4-GL
9.2	11.0	9.3	7.5	11.0	26.0	38.3	14.0	13.0	EP 285 B 5-GL
9.9	11.7	10.0	8.3	11.0	27.0	39.2	14.0	13.5	EP 285 B 6-GL
10.6	12.4	10.6	8.8	11.0	28.0	40.1	14.0	14.0	EP 285 B 7-GL
11.3	13.22	11.8	9.83	11.0	29.0	42.3	15.0	13.0	EP 285 B 8-GL
12.0	14.2	12.45	10.4	13.0	30.0	43.1	15.0	15.0	EP 285 B 9-GL
12.5	14.6	13.3	11.2	13.0	30.0	43.1	15.0	15.0	EP 285 B 10-GL
13.8	15.9	14.1	12.0	13.0	31.0	44.5	15.5	15.5	EP 285 B 11-GL
14.0	16.35	14.5	12.2	12.7	31.0	44.5	15.5	15.5	EP 285 B 12-GL
15.0	17.2	15.5	13.5	14.1	32.8	47.5	17.0	17.0	EP 285 B 13-GL
16.5	18.8	17.1	14.8	14.0	34.0	48.7	17.0	17.0	EP 285 B 14-GL
17.4	19.55	17.8	15.6	14.0	34.0	48.7	17.0	17.0	EP 285 B 15-GL
17.7	20.3	18.6	16.0	16.0	36.0	51.6	18.0	18.0	EP 285 B 16-GL
18.6	21.15	19.45	16.9	15.6	37.0	52.8	18.5	18.5	EP 285 B 17-GL
19.0	21.7	19.8	17.4	16.3	36.9	53.3	18.5	18.5	EP 285 B 18-GL
20.8	23.5	21.8	18.0	17.0	39.0	56.0	19.5	19.5	EP 285 B 19-GL
21.2	24.0	22.1	19.3	17.0	40.0	57.4	20.0	20.0	EP 285 B 20-GL
22.3	25.2	23.4	20.4	17.0	41.0	58.8	20.5	20.5	EP 285 B 21-GL
23.7	27.0	25.2	21.8	18.5	42.0	60.6	21.0	21.0	EP 285 B 22-GL
25.0	28.3	26.4	23.0	19.5	44.0	63.6	22.0	22.0	EP 285 B 23-GL
26.0	29.5	27.7	24.3	20.2	45.0	64.3	22.15	22.15	EP 285 B 24-GL
28.3	31.3	29.7	26.4	20.0	47.0	67.5	23.5	23.5	EP 285 B 25-GL
29.8	32.85	30.6	28.1	20.0	49.0	70.3	24.5	24.5	EP 285 B 26-GL
32.0	35.5	33.6	29.8	22.0	50.0	71.7	25.0	25.0	EP 285 B 27-GL

Material :
LLD-PE,
linear low density polyethylene

Standard Colour :
yellow

Push fit application.

With strong and flexible side
release-tab for quick removal.

Designed to protect Gas pipes,
Plastics pipes, Steel pipes,
threads and bore holes.

Think Plastic. Go Protec.®

PROTEC
PLASTICS

Should your requirements not be shown please ask for separate quotation.
PROTEC products and specifications are subject to improvement and change without notice.

Tapered Protection Plugs / Caps – Side Release Tab

Same body design as previous EP 285 range with large cover flange and side release tab

TRIPLE ADVANTAGE of PROTEC CAPTOP®

QUALITY. Push fit application. With strong and flexible side release-tab for quick removal. Designed to protect Gas pipes, Plastics pipes, Steel pipes, threads and bore holes.

AVAILABILITY. With over 400 million moulded components shipped from our Oststeinbek / Hamburg logistics center we provide the fastest on time delivery service to all markets and industries.

PHILOSOPHY. Innovative protective closures at the best price in the market.



CAPTOP®



All dimensions in mm

d ₁	d ₂	d ₃	d ₄	H	D	N	G	L	Reference No.
33.8	37.82	36.0	31.94	23.0	52.0	74.8	26.0	26.0	EP 285 B 28-GL
36.39	40.23	38.4	34.52	22.0	54.0	77.5	27.0	27.0	EP 285 B 29-GL
39.24	43.1	41.3	37.24	23.0	60.0	86.0	30.0	30.0	EP 285 B 31-GL
41.3	44.8	43.0	39.5	20.0	70.0	100.5	35.0	35.0	EP 285 B 32-GL
44.4	47.9	46.1	42.6	20.0	64.0	91.8	32.0	32.0	EP 285 B 33-GL
45.2	49.6	48.0	43.6	27.0	66.0	93.6	32.0	32.0	EP 285 B 34-GL
46.6	51.2	49.6	45.0	26.0	68.0	95.7	32.0	32.0	EP 285 B 35-GL
54.0	59.3	57.7	52.4	26.0	76.0	104.5	32.0	32.0	EP 285 B 37-GL
58.4	62.8	61.1	56.7	26.0	80.0	115.0	40.0	40.0	EP 285 B 39-GL
60.8	66.05	64.42	59.17	30.0	85.0	122.0	42.5	42.5	EP 285 B 40-GL

Should your requirements not be shown please ask for separate quotation.

PROTEC products and specifications are subject to improvement and change without notice.

Material :
LLD-PE,
linear low density polyethylene

Standard Colour :
yellow

Individual Productions :
On request we develop and produce individually tailored solutions next to the standard items of this range: additional dimensions, different materials and new colours

We would be pleased to advise you.

Think Plastic. Go Protec.®

PROTEC
PLASTICS